

Safe data reading from CAN bus

CANCrocodile Mini reads CAN j1939 bus messages without cutting wire insulation and electrical contact.

- ✓ For vehicles and stationary machines with CAN j1939 bus.
- ✓ Data transfer to any telematics unit with CAN-port.
- ✓ Protecting vehicle electronic systems against active requests from telematics unit.
- ✓ Reliable data transfer, less than 1% message losses.
- ✓ Compact body, quick and easy installation.

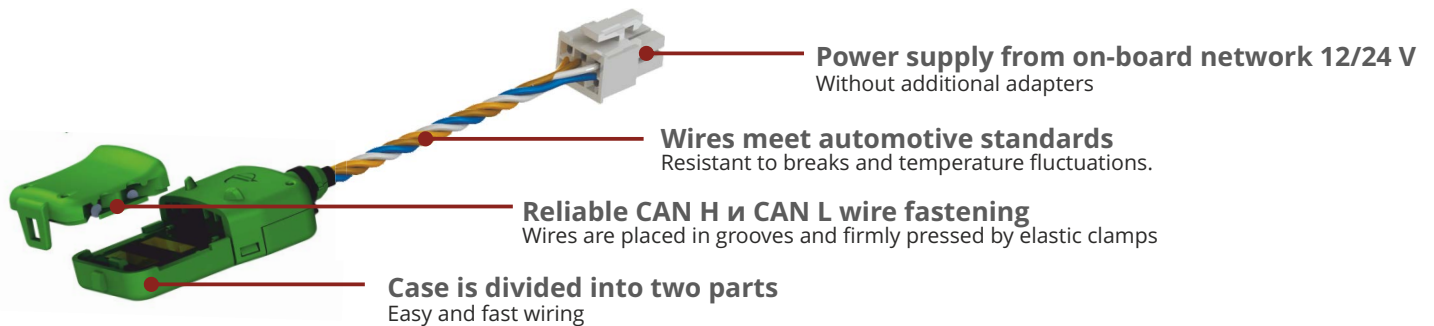

Easy installation - no special tools needed

1. Open CANCrocodile Mini case, remove the upper "jaw".
2. Place the wires in the upper "jaw", fix with clamps.
3. Close the case until click and connect CANCrocodile Mini wires to telematics unit's CAN-port and electrical network of vehicle.

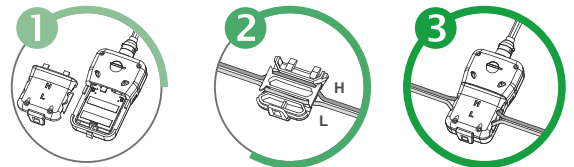

Properties

- ✓ Reduced overall dimensions – easy installation in tight spaces.
- ✓ Sectional case – quick CAN H and CAN L wiring.
- ✓ LED indication of operating modes: ● – power on, ● – data transfer in progress.

Specifications

Power supply voltage	10...50 V
Compatibility	SAE J1939, CAN Open, DeviceNet, NMEA 2000
Baud rate	up to 1000 kb/s
Level of message losses, 0 – 500 kb/s baud rate	no losses
Level of message losses, 500 – 1000 kb/s baud rate	not more 1 %
Output cable length, basic version	0,7 m
Operating temperature	-40...+85 °C



phone +375 17 240 39 73
 Viber/WhatsApp/Telegram +375 44 792 67 58
 e-mail: sales@technoton.by
 www.jv-technoton.com

