

Electrical Characteristics	
Impedance	50 Ω
Frequency Range	0-4 GHz
V.S.W.R.	≦ 1.35
Dielectric Withstanding Voltage	≧ 800 VRMS at sea level

Mechanical Characteristics	
Plastic housing retention force	≧ 90 N
Cable retention force	≧ 100 N
Temperature range	-40°C / +105°C

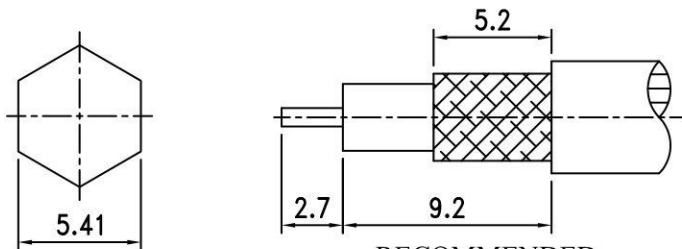

RECOMMENDED
CRIMPING TOOL SIZE

RECOMMENDED
CABLE STRIPPING DIM'S

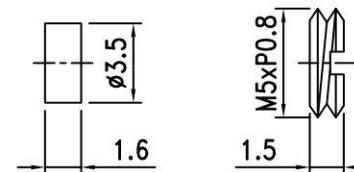
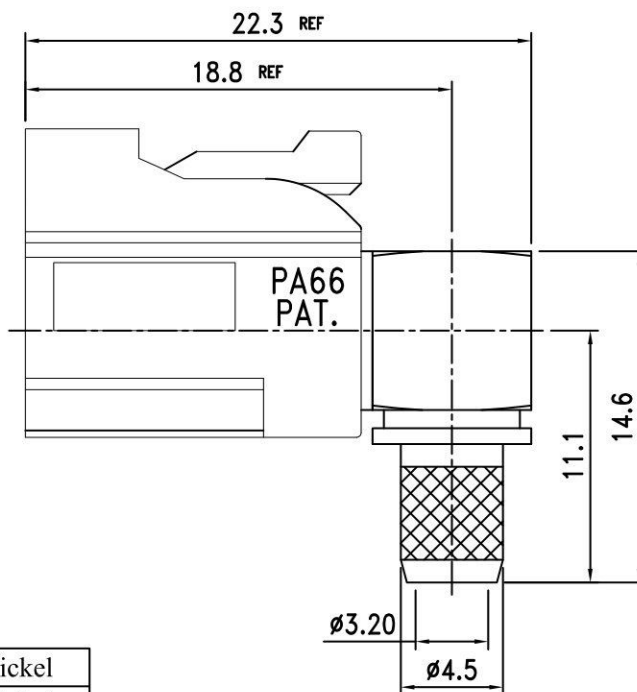
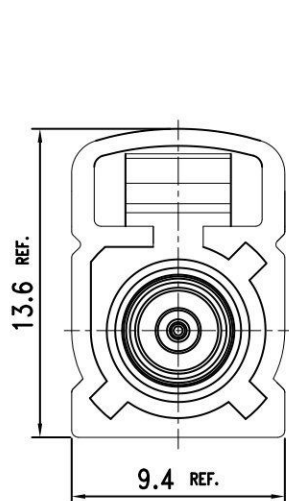
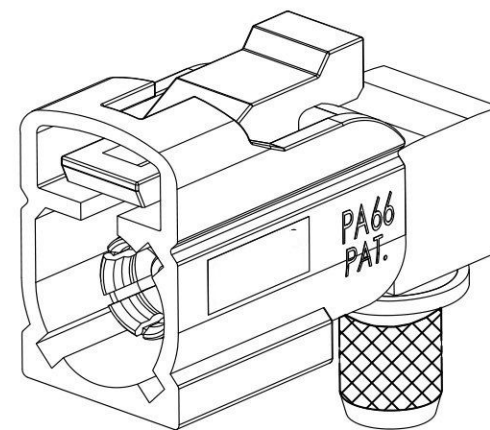

9.	Ferrule	Brass	1	Nickel
8.	Nut	Brass	1	Nickel
7.	Housing	PA66	1	Water Blue
6.	Retaining Ring	Beryllium	1	Nickel
5.	Insulation	Delrin	1	None
4.	Insulation	PTFE	1	White
3.	Pin	Phosphor Bronze	1	Gold
2.	Body	Brass	1	Nickel
1.	Body	Brass	1	Nickel
NO.	DESCRIPTION	MATERIAL	Q' TY	FINISH

繪圖DRAWN	SCALE	UNITS	FC-NEU-F58RA		
	比例 3:1	單位 mm			
審核CHECKED	公差TOLERANCE		圖名		
	.X	±0.2	TITLE		
主管APPROVAL	.XX	±0.1	版次REV.	電腦圖檔CAD FILE	日期DATE
	.XXX	±0.05	A		2016.03.02
	ANGLE	±0.5°			

ROHS
COMPLIANT